

High Speed Inline Pressure Sealer
Interfaced with RISO ComColor 9150 - COLOR INKJET PRINTER

MAILFINISHER 9150



RISO ComColor 9150 is the fastest color inkjet
printer in the market (150ppm)



On-demand PRINTING and PRESSURE SEALING SOLUTION

Your desired pressure sealing application is now easier than ever. Mailfinisher9150 is a highly durable & flexible single mailer with the capability to handle complex jobs. Recommended for Hybrid Mailing Job.

Feature I FLEXIBILITY

Running both pre-printed form and blank form are supported with color inkjet printer. Blank form brings immediate realization of unlimited applications.



Both sides pre-printed form



One side pre-printed form



Both sides blank form

- Full page printing by using blank form minimizes the need to stock various forms.
- Easy design change increases flexibility and work efficiency.
- Taking small orders can create additional value to clients and revenue to service providers.

Feature II PRODUCTIVITY

High speed inkjet printer achieves both high productivity and low cost printing. Welltec Buffer/Feeder (BFU), Vertical Transfer (VTU), Aligner (AU), Folder/Pressure Sealer (FPU) supports production level inline solution.

- The fastest color inkjet printer: 150ppm (landscape)
- Incomparably-low printing cost vs laser printers
- Built to last for high production environment



RISO ComColor 9150
High Capacity Tray (HCT)
 enables feeding capacity up to
 5,500 sheets



Feature III RELIABILITY

16+ years know-how in pressure sealing mechanism enhances job reliability through entire process of buffering-feeding-aligning-folding-sealing-stacking.

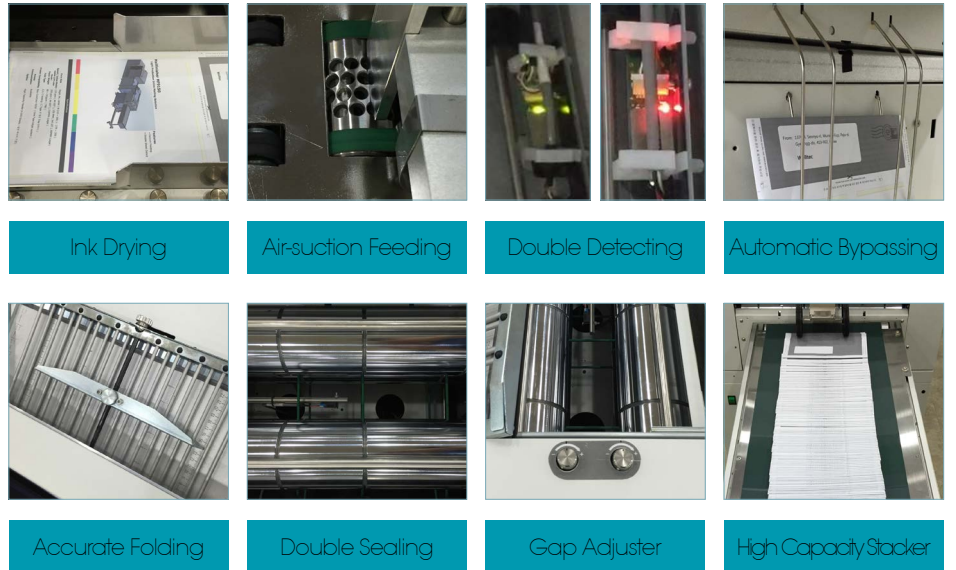

Feature IV MULTI MODAL

PRE-printed pressure seal forms can be folded and sealed at much higher speed.

Standalone processing speed up to 16,500 sheets per hour

Feature V INK DRY

BFU holds printed forms for minutes to dry ink during the forms moves from top to bottom for seamless process. Drying time is adjustable depending on form conditions.

Floor Plan

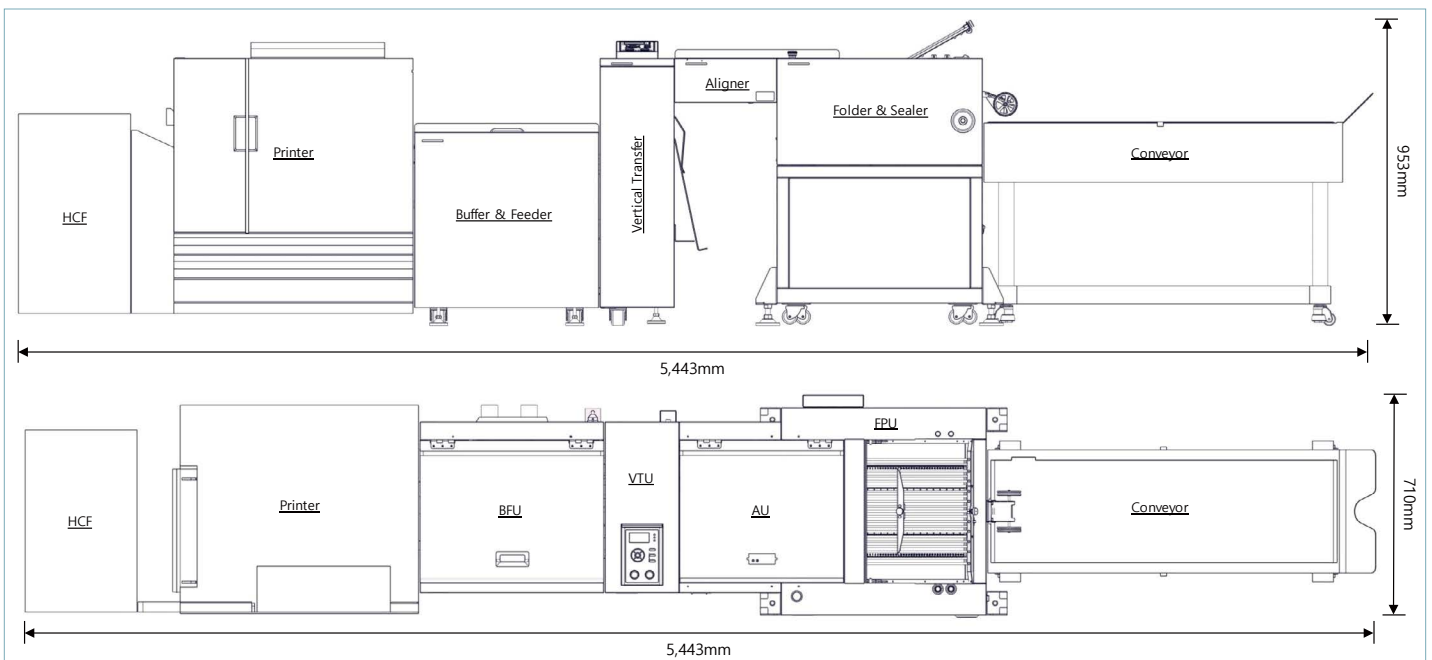



SPECIFICATIONS

BUFFER / FEEDER UNIT (BFU)

Paper Weight	70~120gsm
Paper Size	Width 200~300mm
	Length 200~356mm
Dry Time	Max 180 seconds (adjustable)
System	Air Suction, Belt and Pulley
Double Detect	Ultrasonic Sensor
	LED Light Change from Green to Red
	Divert Tray

FOLDER / SEALER UNIT (FPU)

Fold Type	Z, V and C
	Cassette Folding
Sealer	Integral Four Roller System
Power Source	3 phases, 220~240VAC ±10%, 0.75kw
Environment	Temperature: 10°C ~ 32°C
	Humidity: 20% ~ 80% RH
	Recommended: 23°C, 65%
Speed	Up to 16,500 sheets per hour

PRINTER

Print Type	Line-type Inkjet System		
Ink Type	Oil-based Pigment Ink (C, M, Y, K)		
Resolution	Standard: 300 x 300dpi		
	Fine: 300 x 600dpi		
	Line Smoothing: 600 x 600dpi		
Speed	Job	PPM	Remarks Simplex / Duplex *Long Edge Feeding is not served for pressure seal forms
	Legal SEF	90 / 45	
	A4 SEF	110 / 55	
	Letter SEF	116 / 58	
	A4 LEF	150 / 75	
	Letter LEF	146 / 73	
Print Area	Max. 314 x 548mm		
Feeder	Tray 1: 50mm (500 sheets)		
	Tray 2: 50mm (500 sheets)		
	Tray 3: 50mm (500 sheets)		
	Optional High Capacity Tray 440mm (4,000 sheets)		
Main Memory	1GB		
HDD	320GB		
Dimensions	1,220 x 705 x 1,030mm (D x W x H)		
Weight	Approximately 171kg		

